



An Roinn Iompair,  
Turasóireachta agus Spóirt  
Department of Transport,  
Tourism and Sport

# Traffic Signs Manual

Current Review and Updates

Bernard Sweeney

May 8<sup>th</sup> 2019

Lyrath Estate Hotel, Kilkenny.

# Contents



Current Update of the TSM

Advice Notes

Website

1979-1982



1986



1996



2010  
2015

History

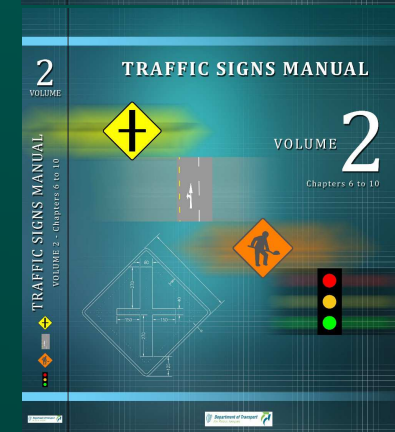
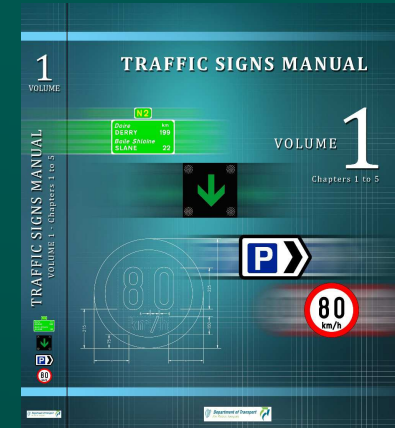
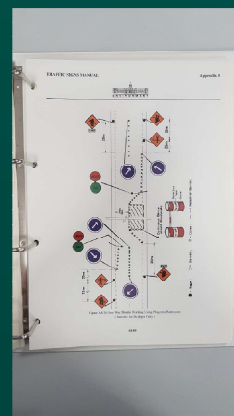
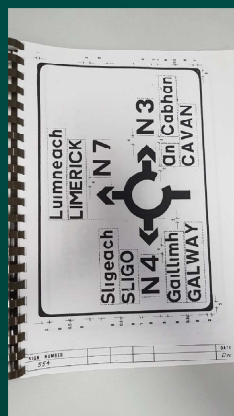
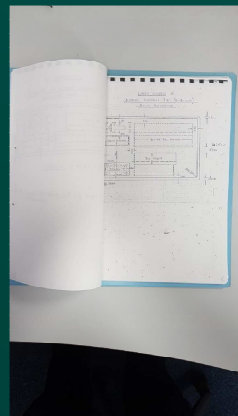
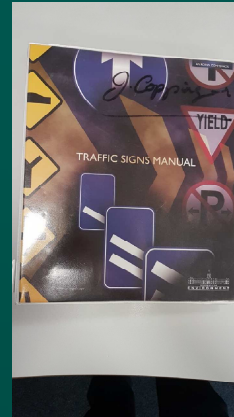
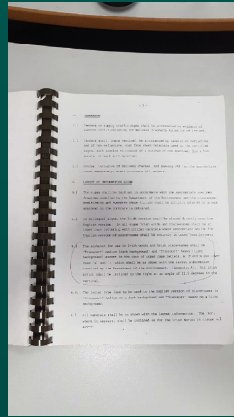



2019 = 6<sup>th</sup> Version

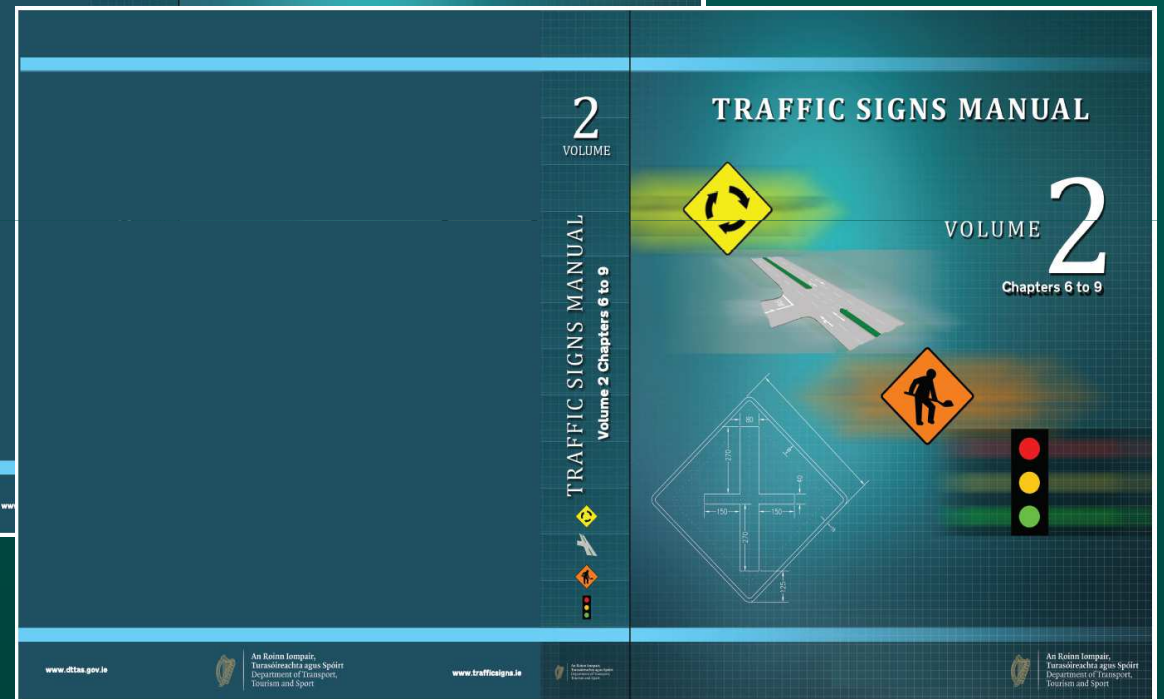



# Current Update of the TSM

---



INTRODUCTION AND SIGN LOCATION

CHAPTER 1  
April 2019





# Cardinal Reference Symbols

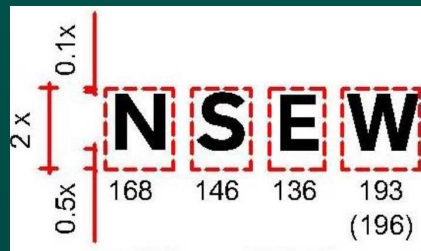

## Terminal Destinations Updated Use of IATA codes

2.2.19 Where an airport name is displayed with the Airport symbol the IATA Airport code may be used instead of the name. e.g. for Ireland West Airport – NOC.

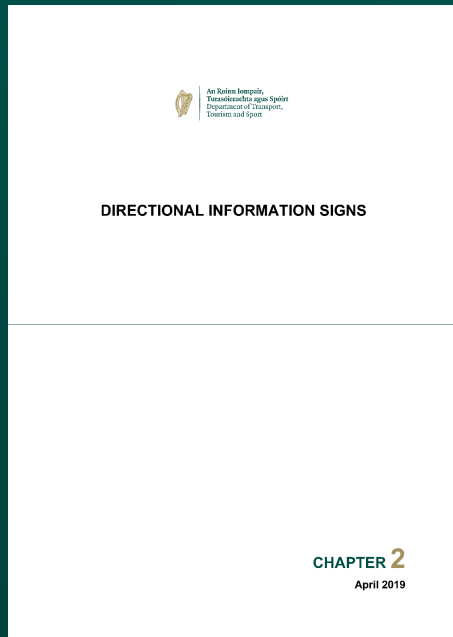



# Figure 3.4 - Revised

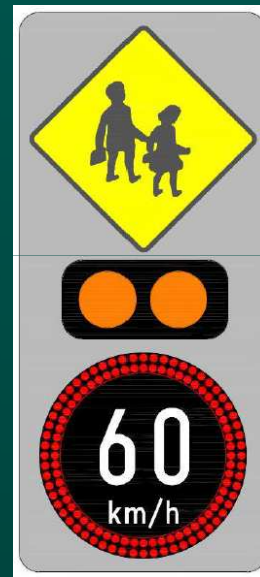
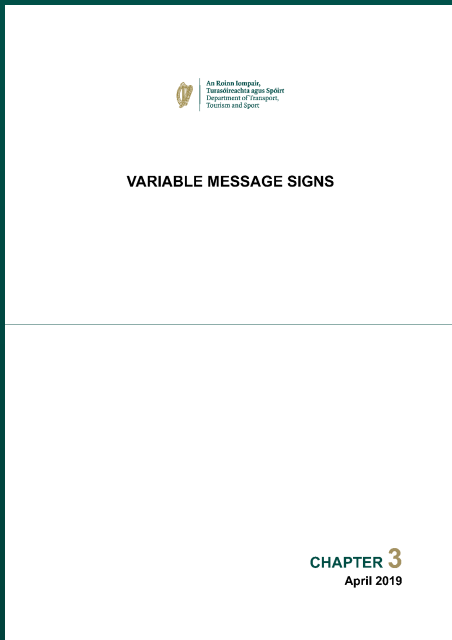

3.3.9 This sign or combination of signs **may** be provided on one or both sides of the road at the entry point of the section of road defined in the relevant bye-law. At the end of the defined section of road, permanent signs shall be provided indicating the relevant speed limit beyond the Periodic Speed Limit (see Chapter 5). These can normally be mounted on the rear of the Periodic Speed Limit signs.





more on this later... 





# 20 km/h..... .....not the new Very limited/s EV Regulator

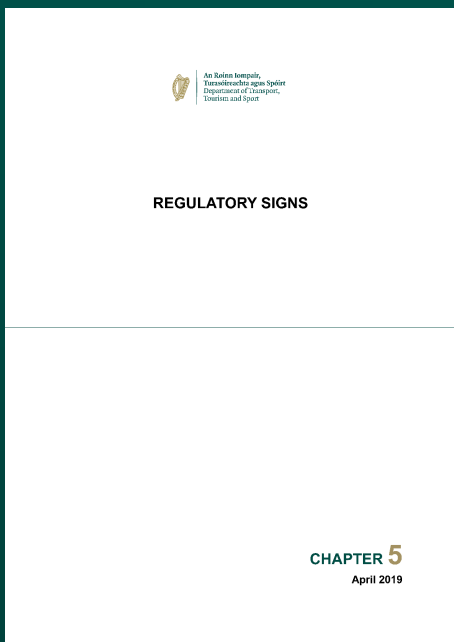

Road Authorities may only introduce a 20 km/h speed limit where Warrant Number 1 applies and where one of the sub-categories of Warrant 2 also applies:

1. The 85th percentile speed of traffic on a street does not exceed 30 km/h and one of the following also applies;
2. (a) In a largely pedestrian zone where the speed limit is limited to 20 km/h or less; or  
(b) On a street which is subject to limited access for certain times; or  
(c) On a shared surface street in an urban area where there are no separate footways.

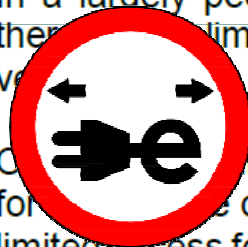

ELECTRIC VEHICLE CHARGING ONLY	Luchtú D'fheithicil Leictreach Amháin
--------------------------------	---------------------------------------

more on this later...



Surfacing joints not to be placed where longitudinal lines are required (para 7.3.7).  
 Centreline to be omitted on roads less than 5.0m wide, to be provided on roads greater than 6.0m wide and is optional on roads between 5.0m and 6.0m in width (paras 7.3.12 and 7.3.14).

Centreline marking to be 100mm wide on roads of 80km / or less and to be 150mm wide on roads of higher speed (para 7.3.13).



Reference to constraint imposed by necessity to use bilingual information has been removed (para 7.5.27).

Use of warning line along downhill side of climbing lane permitted (para 7.3.38).

Changes to stud spacings: continuous centreline to have 6m stud spacing; warning centreline line to have 12m spacing generally.

Clarification on the use of green studs at junctions.

Requirements outlined for the marking of passing bays (recently introduced in TII Standards); markings for nearside passing bays (no longer in TII Standards) removed from the Chapter. Associated changes to various figures.

  
 An Roinn Iompair,  
 Turasóireachta agus Spóirt  
 Department of Transport,  
 Tourism and Sport

**ROAD MARKINGS**

---

**CHAPTER 7**  
 April 2019



Your PC ran into a problem that it couldn't handle, and now it needs to restart We're just collecting some error info, and then we'll restart for you.

If you'd like to know more, you can search online later for this error: `DPC_WATCHDOG_VIOLATION`

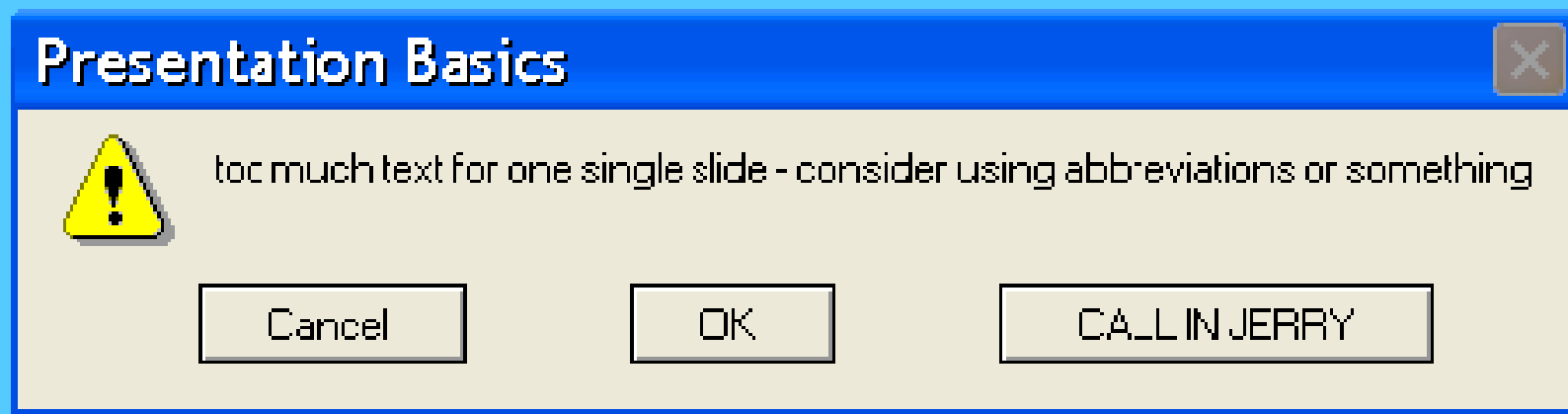

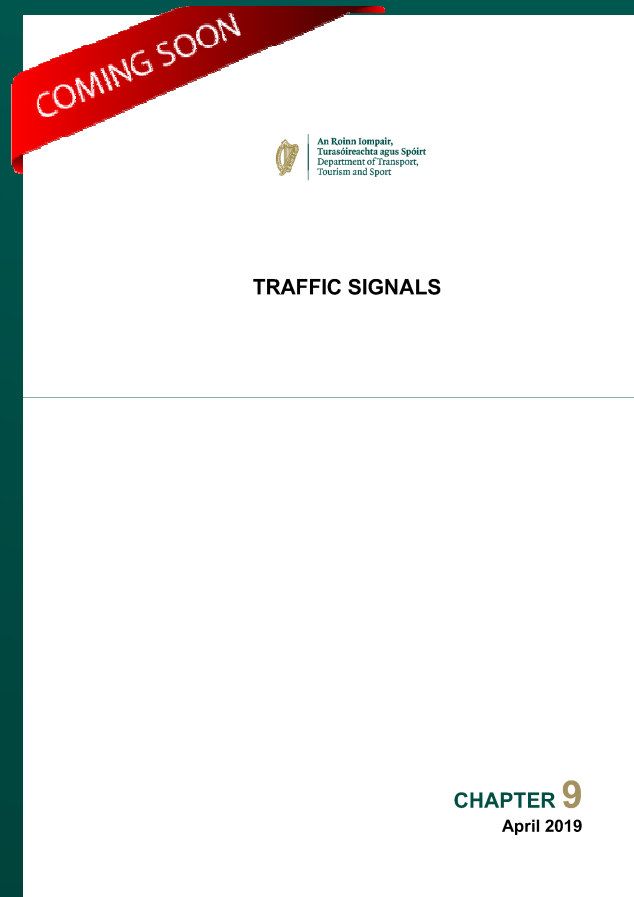
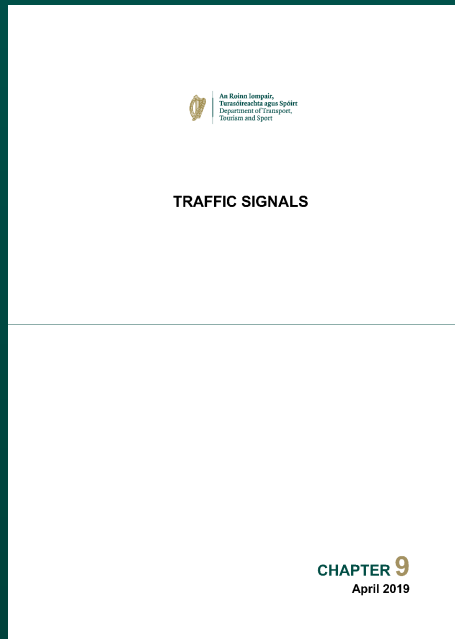



10. Typical Applications for Traffic Signs and Road Markings

**CHAPTER 10**



[www.trafficsigns.ie](http://www.trafficsigns.ie)



# Advice Notes







- 80 km/h speed limit remains
- Visual target removed
- Single Lane Local Tertiary
- Selected Secondaries
- Not for other messages



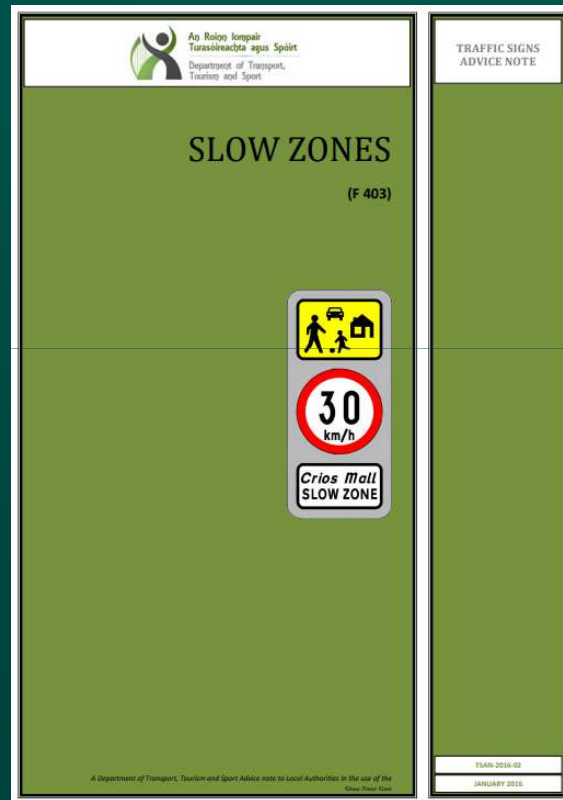

- Entry points to housing estates
- Reduce incident severity
- Enhance quality of life
- Not for other 30 km/h areas



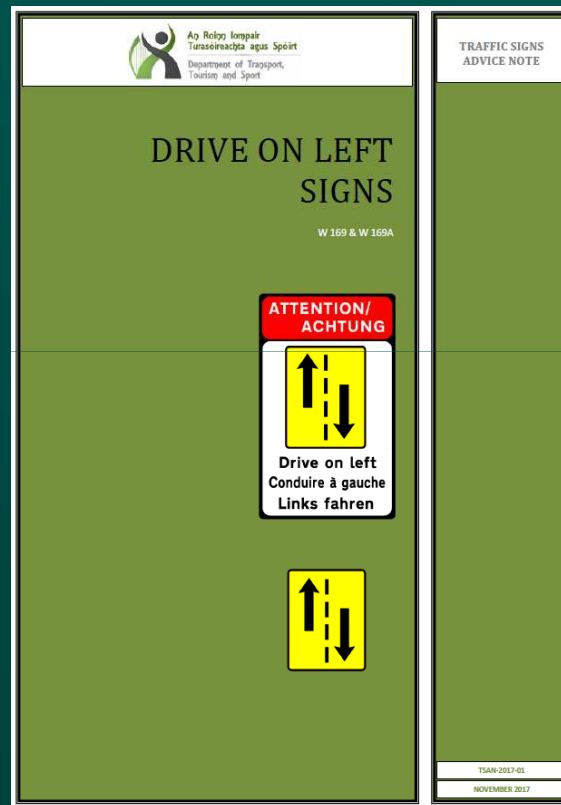

- Updated sign(s)
- Entry points
- Tourist attraction areas
- Supplemented by road markings
- Currently being trialled







# Website

---

*trafficsigns.ie*

# Traffic Signs Advice Notes

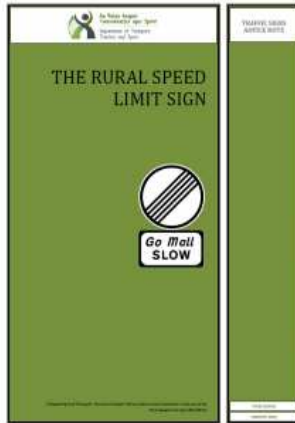

**PDF** Rural Speed Limit Sign Advice Note (TSAN-2016-01)



Website



- Current and superseded TSM
- Working Drawings
- Typical Applications
- Advice Notes
- etc

**Home**

[Current Traffic Signs Manual](#)

[Previous Traffic Signs Manual Chapters](#)

[Working Drawings](#)

[Typical Applications \(Signs and Road Markings\)](#)

[Traffic Signs Advice Notes](#)

[Circulars](#)

[Legislation & S.I.'s](#)

[Temporary Traffic Management Guidelines](#)

[Other Documents](#)

[Links](#)

**LOCATION**

 [Click to open a larger map](#)

[Subscribe](#) 



An Roinn Iompair,  
Turasóireachta agus Spóirt  
Department of Transport,  
Tourism and Sport

# Go raibh maith agat

Bernard Sweeney – Kildare County Council DTTAS Support Office

[bernard.sweeney@dtassupportoffice.ie](mailto:bernard.sweeney@dtassupportoffice.ie) | 045-988 951 | 087-278 9617

